

S E R I E S
VS-200-3000
 P A N T H E R

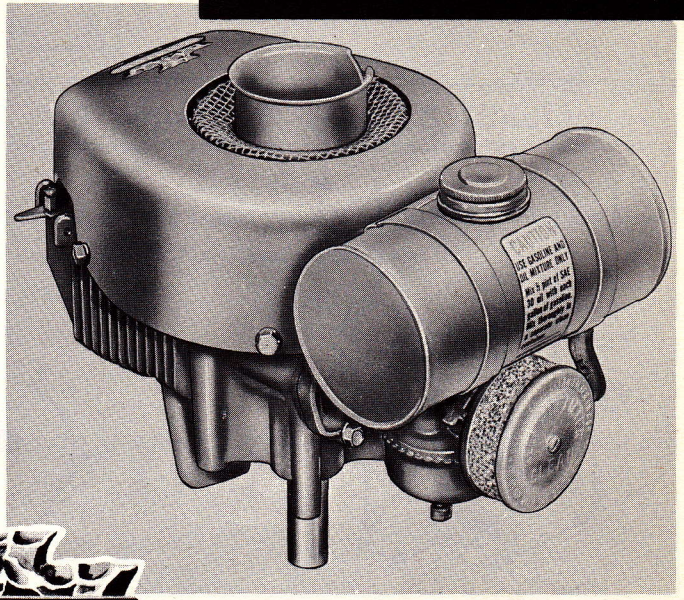
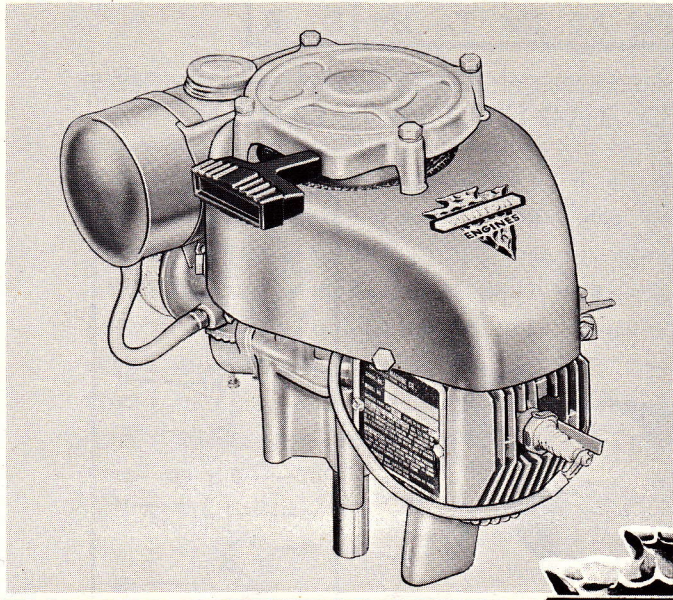

A Wide Range of Models are Made By **CLINTON** For Farm, Home and Industrial Use.

CLINTON
ENGINES

VS-200-3000

H.P.	R.P.M.
1.3-----	2200
1.7-----	2800
2.25-----	3800

GENERAL SPECIFICATIONS

Model	Type	Description	Starter	Weight
VS-200-3000	Air Cooled	Vertical Shaft	Rope or Recoil	15½ lb.

BORE: 1⅞".

STROKE: 1⅝"

TYPE: Single cylinder, vertical shaft, air-cooled.

AIR-COOLED: Powerful flywheel blower forces strong air blast through deep cooling fins on cylinder and cylinder head to maintain correct operating temperature.

PISTON DISPLACEMENT: 4.5 cu. inches.

IGNITION: Very high voltage, built-in flywheel magneto for faster starting. Moisture and dust proof with fully enclosed ignition points. Positive safety ON-OFF device on spark plug.

SPARK PLUG: 14 mm.

LUBRICATION: Lubricating oil carried in fuel to all moving parts.

CARBURETOR: Full float feed with high speed adjustment.

GOVERNOR: Adjustable pneumatic type.

MAIN BEARINGS: Bronze.

CRANKSHAFT: Ductile iron, has counterweights integral with shaft. Bearing surfaces superfinished.

CONNECTING ROD: I-beam aluminum alloy with bronze crank pin and wrist pin bearings.

PISTON: Aluminum alloy, Clinton-engineered for efficient combustion.

PISTON RINGS: Two compression rings.

CYLINDER AND CRANKCASE: One-piece die cast cylinder block and crankcase with large amount of cooling area for cool operation. A close-grained cast iron liner is die cast in block.

CYLINDER HEAD: Integral with cylinder casting.

AIR CLEANER: Metallic mesh dry type.

FUEL TANK: One-quart capacity.

DIRECTION OF ROTATION: Counter-clockwise, viewed from power take-off shaft side.

FINISH: Red heat-resisting enamel. Other colors available upon request.

STANDARD EQUIPMENT

Standard equipment includes: Cast iron cylinder liner, replaceable bearing, air cleaner, specially designed dust and moisture-proof high voltage flywheel magneto, fuel tank, splash-proof gas tank cap, muffler, blower housing screen, rope starter. Safety stop device, remote throttle cable mounting.

SPECIAL EQUIPMENT

Special equipment includes: Remote throttle cable and controls, recoil starter, shorting terminal for remote stop hookup, 8-inch circle mounting adapter plate, deluxe muffler, special paint finishes, resistor spark plug, special crankshaft extensions, gas tank shroud. (Quotations available on request.)

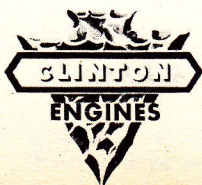

WORLD'S LARGEST MANUFACTURER OF A COMPLETE LINE OF AIR-COOLED GASOLINE ENGINES

CLINTON ENGINES PROVIDE POWER

FOR FARM • HOME • INDUSTRIAL EQUIPMENT

PRINTED IN U.S.A.

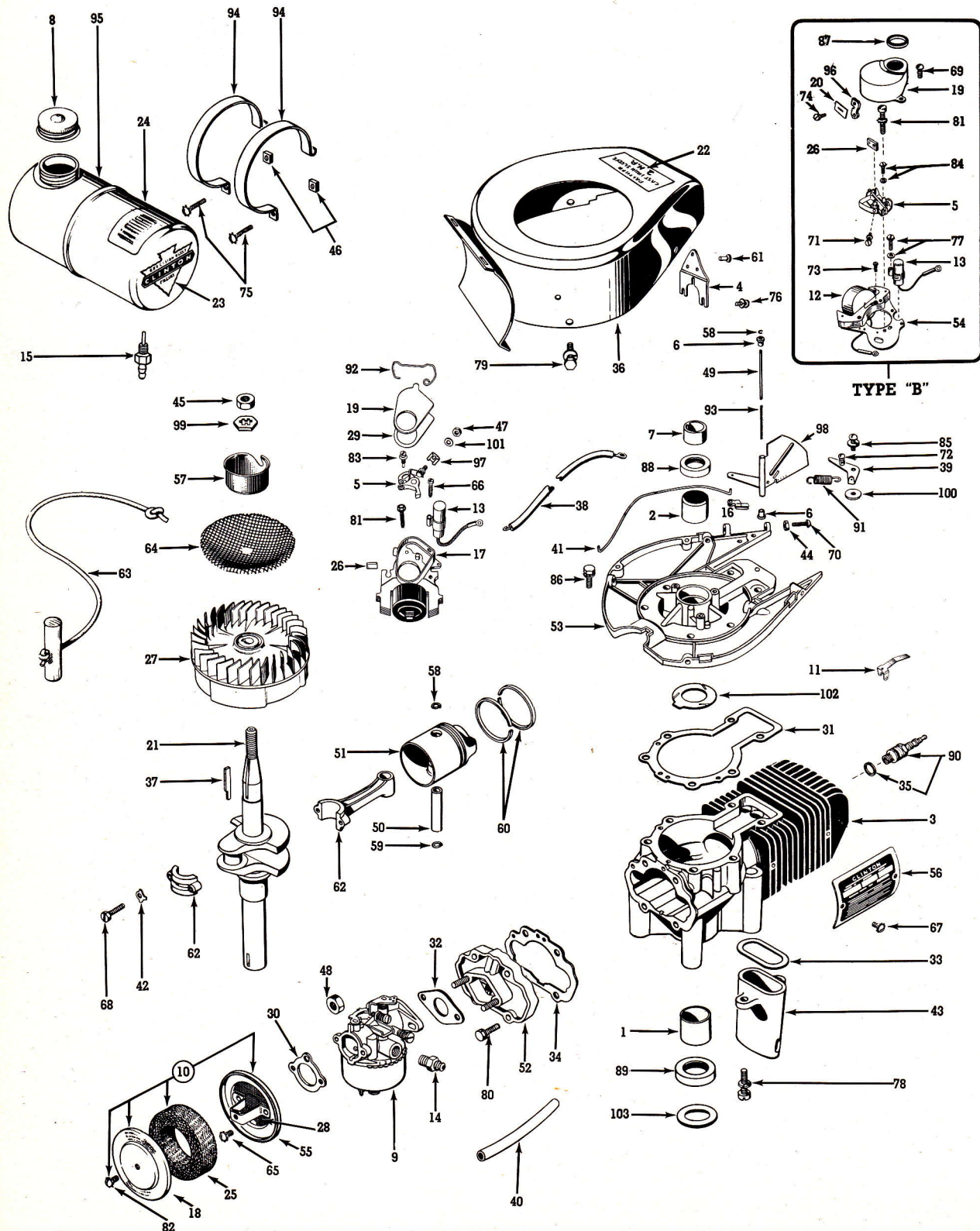

CLINTON

S	E	R	I	E	S	
VS-200-3000						
P	A	N	T	H	E	R

**BASIC
TYPE**
**SEC. II, DIV. VS-200-3000
PARTS CATALOG**
 Revised November, 1959
 Supersedes Dec., 1958

There are three Basic Types of the VS-200-3000 Engine covered by this Basic Parts List. Parts not used on all types are noted. The VS-200-3000 series are shown as follows: Serial Number Suffix "A"—referred to as Type A; Serial Number Suffix "B"—referred to as Type B; Serial Number Suffix "C"—referred to as Type C.

NOTE: See page "a" on "How to Identify Your Clinton Engine."

BASIC PARTS LIST

Ref. No.	PART DESCRIPTION	Part No.	Quantity
1	BEARING — Main Sleeve (Block Assembly).....	9016	1
2	BEARING — Sleeve (Bearing Plate).....	2059	1
3	BLOCK ASSEMBLY — Cylinder (Includes Ref. Nos. 1 & 89) (Used on Types A & B).....	2278-A	1
	BLOCK ASSEMBLY — Cylinder (Includes Ref. Nos. 1 & 89) (Used on Type C).....	2282-A	1
4	BRACE — Blower Housing.....	2127	1
5	BREAKER POINTS ASSEMBLY — (Includes Ref. Nos. 26, 71 & 84) (Used on Type B).....	P5543	1
	BREAKER POINTS ASSEMBLY — (Includes Ref. Nos. 26, 47, 83 & 101) (Used on Types A & C).....	P5735	1
6	BUSHING — Air Vane.....	7239	2
7	CAM — Breaker Points (Used on Type B).....	P5594	1
	CAM — Breaker Points (Used on Types A & C).....	5751	1
8	CAP & GASKET ASSEMBLY — Fuel.....	4517-A	1
9	CARBURETOR ASSEMBLY — Clinton.....	14069	1
	For complete identification of Carburetors, refer to Section III, Div. A, Page 2.		
10	CLEANER ASSEMBLY — Air.....	2000-A	1
11	CLIP — Ignition Shorting.....	3499	1
12	COIL — Magneto (Without Laminations) (Used on Type B).....	P5593-A	1
	COIL — Magneto (Without Laminations) (Used on Types A & C).....	P5733-A	1
13	CONDENSER — Magneto.....	P5589-A	1
14	CONNECTOR — Fuel Line (Flexible) (Carburetor).....	5053	1
15	CONNECTOR — Fuel Line (Tank).....	5055	1
16	CONNECTOR — Governor Link to Air Vane.....	2226	1
17	CORE & BREAKER BOX ASS'Y — (Used on Types A & C).....	P5732	1
18	COVER — Air Cleaner.....	2003	1
19	COVER — Dust, Magneto Breaker Points (Used on Types A & C).....	P5743	1
	COVER — Dust, Magneto Breaker Points—With Seal (Used on Type B)	P5595-A	1
20	COVER — Breaker Points Terminal (Used on Type B).....	P5714	1
21	CRANKSHAFT.....	2370-1	1
22	DECAL — Horsepower.....	90597	2
23	DECAL — Arrowhead.....	90559	1
24	DECAL — Instruction, Fuel Mixture.....	2098	1
25	ELEMENT — Air Cleaner.....	2132	1
26	FELT — Lubrication, Cam Follower (Used on Type B).....	P5504	1
	FELT — Lubrication, Cam Follower (Used on Types A & C).....	P5742	1
27	FLYWHEEL ASSEMBLY.....	5753-A	1
28	GASKET — Air Cleaner to Mounting Plate.....	21056	1
29	GASKET — Breaker Points Cover (Used on Types A & C).....	P5744	1
30	GASKET — Air Cleaner to Carburetor.....	3990	1
31	GASKET — Bearing Plate (Standard, .030 thick).....	2039	1
	NOTE: Gaskets are also available in the following thicknesses: .025 and .035. Order by Part Number and specify thickness.		
32	GASKET — Carburetor to Reed Plate.....	2096	1
33	GASKET — Muffler to Block.....	2069	1
34	GASKET — Reed Plate to Block.....	2344	1
35	GASKET — Spark Plug.....	3115	1
	GASKET KIT — Engine Overhaul.....	2203	1
	NOTE: Kit contains all necessary Gaskets and Oil Seals.		
36	HOUSING — Blower and Bracket Assembly.....	90456-A	1
37	KEY — Flywheel.....	10339	1

CLINTON

S E R I E S
VS-200-3000
P A N T H E R

**BASIC
TYPE**

BASIC PARTS LIST (Continued)

Ref. No.	PART DESCRIPTION	Part No.	Quantity
38	LEAD — High Tension Magneto	P2055	1
39	LEVER AND SCREW ASSEMBLY — Throttle Control	2043-A	1
40	LINE — Fuel (Flexible)	6316	1
41	LINK — Air Governor	90569	1
42	LOCK — Connecting Rod Cap	2027	2
43	MUFFLER	2082	1
44	NUT — Hexagon, 8-32 (Speed Control Adjusting)	5522	1
45	NUT — Starter Pulley	5877	1
46	NUT — Fuel Tank Straps	3253	2
47	NUT — Terminal Condenser Lead (Used on Types A & C)	5740	1
48	NUT & L'WASHER ASS'Y — Carburetor to Reed Plate Ass'y	3255-A	2
49	PIN — Pivot, Air Vane	7238	1
50	PIN — Wrist	2028	1
51	PISTON — Standard	2030	1
	PISTON ASSEMBLY — Standard	2030-D	1
	NOTE: Piston and Piston Assemblies are available in the following oversizes: .005, .010 and .020. Order by Part Number and specify oversize.		
	NOTE: Piston Assembly includes Ref. Nos. 50, 51, 59, and 60.		
52	PLATE — Reed Valve Assembly (Includes Reed Valves and Stops)	90467-A	1
53	PLATE — Bearing	2312-A	1
	NOTE: Bearing Plate includes Ref. Nos. 2 and 88.		
54	PLATE ASSEMBLY — Magneto with Coil and Laminations (Used on Type B)	P5590-B	1
55	PLATE ASSEMBLY — Air Cleaner Mounting	21055-A	1
56	PLATE — Name	2363	1
57	PULLEY — Starter	12397	1
58	RETAINER — Air Vane	4430	1
59	RETAINER — Wrist Pin	2029	1
60	RING — Piston, Standard	2056	2
	RING SET — Piston — Standard	2200	1
	NOTE: Ring Sets are also available in the following oversizes: .005, .010, .020. Order by Part Number and specify oversize.		
61	RIVET — Tubular (Brace to Housing)	5460	3
62	ROD ASSEMBLY — Connecting	2022-D	1
63	ROPE ASSEMBLY — Starting	4266	1
64	SCREEN — Rotating	90092	1
65	SCREW — H.H.C., 8-32 x 7/16 (Air Cleaner Mounting)	5812	2
66	SCREW — R.H.S.T., 16-32 x 13/16 (Condenser to Plate) (Used on Types A & C)	5741	1
67	SCREW — H.H.S.T., 8-32 x 3/8 (Name Plate to Block)	5644	2
68	SCREW — H.H.S.T., 10-24 x 3/4 (Connecting Rod Cap)	5429	2
69	SCREW — R.H.S.T., 6-32 x 3/8 (Breaker Cover to Bearing Plate) (Used on Type B)	5405	2
70	SCREW — R.H.M., 8-32 x 7/8 (Speed Control Adjusting)	3240	1
71	SCREW — R.H.M., 6-32 x 1/4 (Breaker Points Terminal) (Used on Type B)	5664	1
72	SCREW — H.H.M., 8-32 x 1/4 (Throttle Lever)	5681	1
73	SCREW — R.H.S.T., 4-40 x 1/4 (Coil to Laminations) (Used on Type B)	5641	1
74	SCREW — R.H.M., 6-32 x 1/4 (Wires to Breaker Points Terminal) (Used on Type B)	7143	1
75	SCREW & L'WASHER ASS'Y — R.H.M., 10-24 x 1 (Fuel Tank Straps)	5421-A	2
76	SCREW & L'WASHER ASS'Y — H.H.C., 8-32 x 1/2 (Brace to Block)	5443-A	3
77	SCREW & L'WASHER ASS'Y — F.H.M., 8-32 x 5/8 (Condenser to Bearing Plate) (Used on Type B)	5674-F	1
78	SCREW & L'WASHER ASS'Y — F.H.M., 1/4-20 x 3/4 (Muffler to Block)	5679-G	2
79	SCREW & L'WASHER ASS'Y — H.H.C., 1/4-20 x 1/2 (Blower Housing to Plate)	3205-G	4
80	SCREW & L'WASHER ASS'Y — H.H.C., 1/4-20 x 3/8 (Reed Plate to Block)	3294-G	4

CLINTON

S	E	R	I	E	S	
VS-200-3000						
P	A	N	T	H	E	R

**BASIC
TYPE**

SEC. II. DIV. VS-200-3000
PARTS CATALOG
Revised November, 1959
Supersedes Dec., 1958

BASIC PARTS LIST (Continued)

Ref. No.	PART DESCRIPTION	Part No.	Quantity
81	SCREW & L'WASHER ASS'Y — R.H.S.T., 10-24 x 1 (Magneto Plate to Bearing Plate).....	5682-A	2
82	SCREW & L'WASHER ASS'Y — R.H.S.T., 8-32 x 3/8 (Air Cleaner Cover to Mounting Plate).....	5457-A	1
83	SCREW & L'WASHER ASS'Y — Breaker Points to Breaker Box (Used on Types A & C).....	5737	1
84	SCREW & L'WASHER ASS'Y — R.H.M., 8-32 x 1/2 (Breaker Points to Breaker Plate) (Used on Type B).....	5409-F	1
85	SCREW & L'WASHER ASS'Y — R.H.S.T., 8-32 x 1/2 (Speed Control Lever).....	5443-D	1
86	SCREW & L'WASHER ASS'Y — H.H.C., 1/4-20 x 3/4 (Bearing Plate to Block).....	5446-F	6
87	SEAL — Breaker Points Cover (Used on Type B).....	5596	1
88	SEAL — Oil (Bearing Plate).....	7254	1
89	SEAL — Oil (Power Take-Off).....	4429	1
90	SPARK PLUG & GASKET ASSEMBLY — (Used on Types A & B).....	K15387-A	1
	SPARK PLUG & GASKET ASSEMBLY — (Used on Type C).....	K90617-A	1
91	SPRING — Air Governor.....	2448	1
92	SPRING — Breaker Box Cover (Used on Types A & C).....	P5745	1
93	SPRING — Compression (Air Vane).....	10005	1
94	STRAP — Fuel Tank.....	90455	2
95	TANK ASSEMBLY — Fuel (Includes Ref. No. 8).....	7461-A	1
96	TERMINAL — Breaker Points (Used on Type B).....	5713	1
97	TERMINAL — Jamtite Breaker Points (Used on Types A & C).....	P5738	1
98	VANE & LEVER ASSEMBLY — Air Governor.....	2323	1
99	WASHER — Starter Pulley.....	5880	1
100	WASHER — Spring Tension (Throttle Control).....	2077	1
101	WASHER — Terminal Condenser Lead (Used on Types A & C).....	5739	1
102	WASHER — Thrust (Crankshaft).....	2026	1
103	WASHER — Oil Seal Protector.....	4558	1

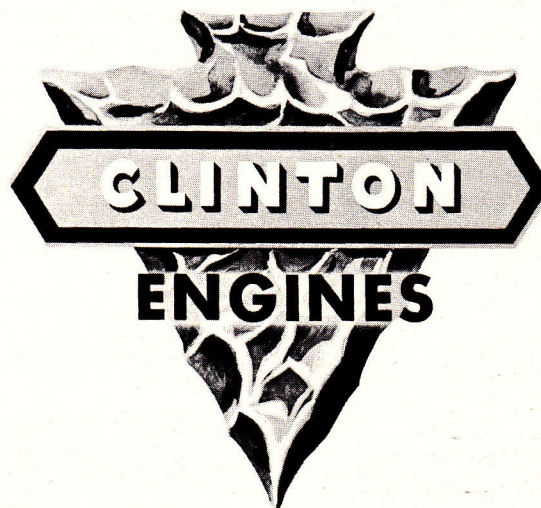

MODEL VARIATIONS OF VS-200-3000 SERIES

The adaptation of Clinton Engines to a wide variety of uses results in what is known as "Model Variations." Following is the complete list of all Models produced up to issue date (shown above). Opposite each Engine Model listed are the Part Numbers and/or Assembly Numbers for the Series used IN ADDITION TO or IN PLACE OF the parts illustrated and shown on the Basic Parts List preceding this Model Variations List. Refer to other sections of this Manual when Assembly Numbers are given to find the Parts List for these assemblies.

See page (a) on "How to Identify Your Clinton Engine." Use the preceding Basic Parts List except as shown below.

ENGINE MODEL—See page (a), "How to Identify Your Clinton Engine."

FOOTNOTES (Check page two).

BASE—ENGINE (Part Numbers Shown). Refer to Sec. IV, Div. A for further information.

BLOCK ASSEMBLY — CYLINDER (Part Number Shown). Refer to Illustrated Basic Parts List for corresponding part.

CRANKSHAFT (Part Numbers Shown). Refer to Sec. IV, Div. B for details and further information.

BEARING—MAIN (Part Numbers Shown). Refer to Illustrated Basic Parts List for corresponding part.

CONTROL GROUP (Control Group Illustration Numbers Shown). Refer to Sec. III, Div. D for Parts List.

CONTROL CABLE LENGTH — Replacement cable is furnished in 72" length ONLY, cut to length shown.

PLATE ASSEMBLY — BEARING (Part Numbers Shown). Refer to Illustrated Basic Parts List for corresponding part.

MUFFLER OR MANIFOLD (Part Numbers Shown). Refer to Illustrated Basic Parts List for corresponding part.

STARTER — RECOIL. Refer to Sec. III, Div. H for Parts List.

HOUSING ASSEMBLY — BLOWER (Part Numbers Shown). Refer to Basic Parts List for corresponding part.

REDUCTION GEAR (Assy. Nos. Shown). Refer to Sec. III, Div. C for Parts List.

MOUNTING POSITION — "Clock" position shows mounting of reduction unit in relation to Crankshaft.

VS-200-3000	NO VARIATION—USE BASIC PARTS LIST			
VS-200-3100	Note 1			
VS-200-3101	Note 1			
VS-200-3102			P90996	90587-A
VS-200-3103	Note 2		Dual P90996	90587-A
VS-200-3104	Note 1			
VS-200-3105			P90996	90587-A
VS-200-3106		2260		
VS-200-3107	Note 1		P90996	90587-A
VS-200-3108	Note 1		P90996	90587-A
VS-200-3109	Note 1			
VS-200-3110	Note 1		P90996	90587-A
VS-200-3111		2260		
VS-200-3112			P90996	90587-A
VS-200-3113	Note 1		P90996	90587-A
VS-200-3114	NO VARIATION—USE BASIC PARTS LIST			
VS-200-3115	Note 2		Dual	
VS-200-3116	Note 1			
VS-200-3117	NO VARIATION—USE BASIC PARTS LIST			
VS-200-3118			P90996	90587-A
VS-200-3119		10174	P90996	90587-A
VS-200-3120		2260	P90996	90587-A
VS-200-3122		2371-1		
VS-200-3123		2372-1	P90996	90587-A
VS-200-3125	Note 1			
VS-200-3126		2371-1	P90996	90587-A
VS-200-3127		2371-1		
VS-200-3128	Notes 3, 4, 5		72" 2220-A	P90996 90587-A
VS-200-3129		2374-1	P90996	90587-A
VS-200-3130	Notes 1 & 5		P90996	90587-A
VS-200-3132	Notes 3, 4, 5, 6		2350-B	P90996 90587-A
VS-200-3134			P90996	90587-A
VS-200-3135	NO VARIATION—USE BASIC PARTS LIST			
VS-200-3136	NO VARIATION—USE BASIC PARTS LIST			
VS-200-3137			P90996	90587-A
VS-200-3138	NO VARIATION—USE BASIC PARTS LIST			
VS-200-3139	Note 1			
VS-200-3141	Note 7	2260	P90996	90587-A
VS-200-3142	Notes 1, 4, 6		2220-A	P90996 90587-A
VS-200-3143	Notes 4 & 8		2220-A	P90996 90587-A

CLINTON

S E R I E S
VS-200-3000
P A N T H E R

**MODEL
VARIATIONS**

PARTS CATALOG
SEC. II, DIV. VS-200-3000
Revised November, 1959
Supersedes June, 1959

MODEL VARIATIONS OF VS-200-3000 SERIES (Cont.)

NOTE 1—Use 2431 Flange and 3217-G Screw & L'Washer (4).

NOTE 2—Use 90466-A Manifold Assembly, 90459 Clamp, 90462 Gasket, 90464-A Muffler (Right Hand), 90465-A Muffler (Left Hand).

NOTE 3—Use 5659 Stud (Muffler) (2), 5498 Washer (2), 3255-A Nut & L'Washer Ass'y (Muffler Hold-Down) (2).

NOTE 4—Use 7466 Switch Assembly, 31484-A Wire Assembly, 5522 Nut.

NOTE 5—Use 5051 Valve (Fuel Shut-Off), 5052 Connector (90°).

NOTE 6—Use 3410 Clamp, 5644 Screw.

NOTE 7—This unit is the same as a VS-400-4000 except as shown.

NOTE 8—Use 5052 Elbow (Hose Connector), 5051 Valve (Fuel Shut-Off), 5659 Stud (Muffler), 5498 Washer (Muffler), 3255-A Nut and L'Washer Assembly.

