

CLINTON

S E R I E S
FV-3100-1000
AFV-3100-1000
CLINTALLOY

BASIC
TYPE

SEC. II, DIV. FV-3100-1000
AFV-3100-1000
PARTS CATALOG
Revised May, 1961
Supersedes March, 1960

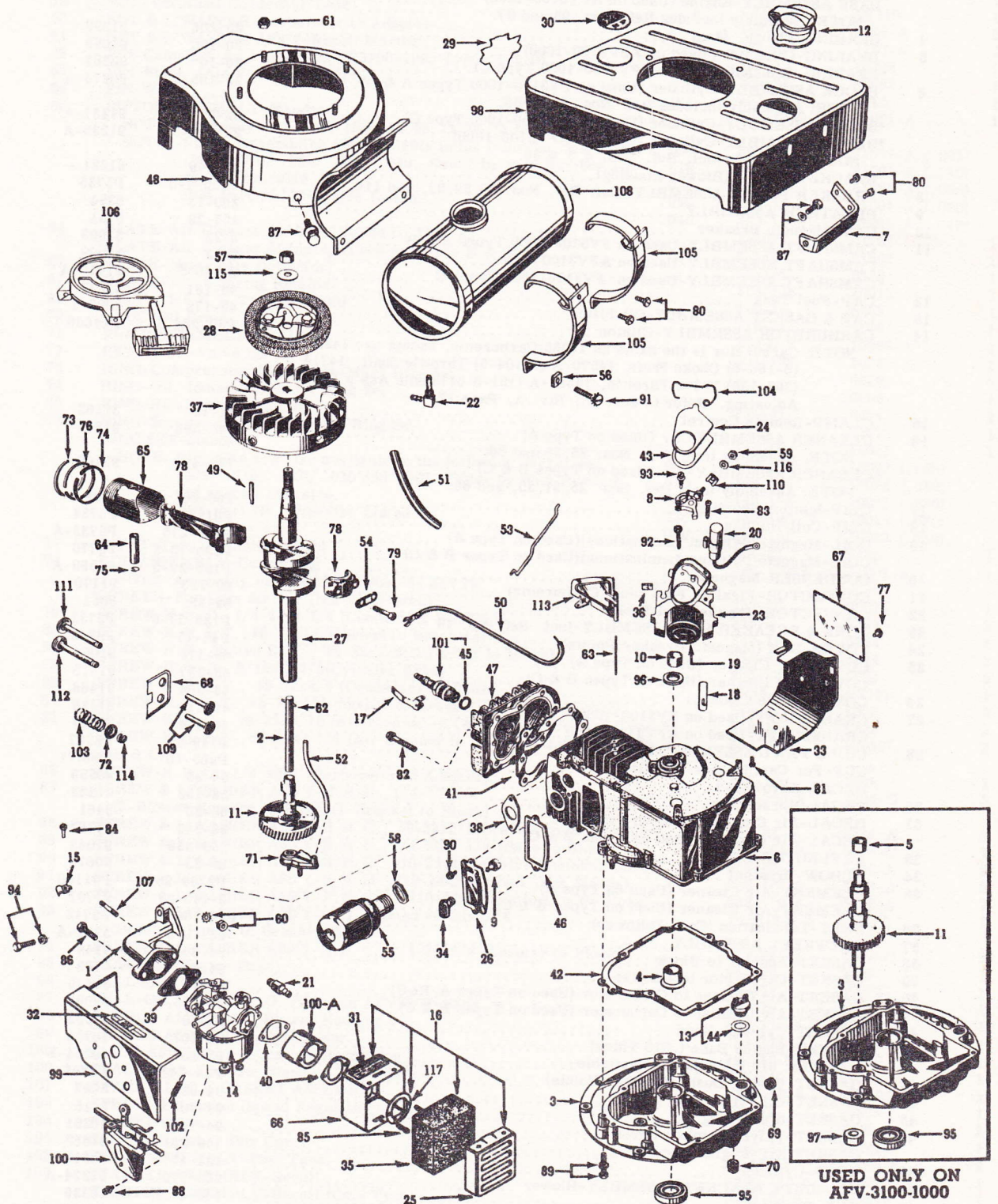

CLINTON ENGINES CORPORATION

MAQUOKETA, IOWA

PRINTED IN U.S.A.

There are three Basic Types of the FV3100-1000 and AFV3100-1000 Series Engines covered by this Basic Parts List. Serial Suffix A-referred to as Type "A", Serial Suffix B-referred to as Type "B". etc.

NOTE: See page "a" on "How to Identify Your Clinton Engine."

Ref. No.	Part Description	IBM No.	Part No.	Quan.
1	ADAPTOR-Carburetor	1-53	91140	1
2	AXLE ASSEMBLY-Camshaft (Used on FV3100-1000 Types A & B)	6-3-5	10310-A	1
3	BASE ASSEMBLY-Engine (Used on FV3100-1000)	18-45	31488	1
	NOTE: Assembly includes Ref. No. 95.			
	BASE ASSEMBLY-Engine (Used on AFV3100-1000)	18-44	31487	1
	NOTE: Assembly includes Ref. Nos. 95 and 97.			
4	BEARING-Flange, Main	20-206	91098	1
5	BEARING-Camshaft (Used on AFV3100-1000)	20-100	91099	1
	*BEARING-Camshaft (Used on FV3100-1000 Type C)	20-10	90281	1
6	BLOCK ASSEMBLY-Cylinder (Used on FV3100-1000 Types A & B)	22-195-5	90274-A	1
	NOTE: Assembly includes Ref. Nos. 4 and 96.			
	*BLOCK ASSEMBLY-Cylinder (Used on FV3100-1000 Type C)	22-519-5	91231-A	1
	*BLOCK ASSEMBLY-Cylinder (Used on AFV3100-1000)	22-520-5	91235-A	1
	NOTE: Assembly incl. Ref. Nos. 4, 5, & 96.			
7	BRACKET-Shroud (Blower Housing)	26-349	91221	1
8	BREAKER POINTS ASSEMBLY-Incl. Ref. Nos. 36, 59, 93, and 116.	P135-7-5	P5735	1
9	BREATHER ASSEMBLY	260-13	6354	1
10	CAM-Magneto Breaker	157-29	5751	1
11	CAMSHAFT ASSEMBLY-Used on FV3100-1000 Types A & B	6-22	31008	1
	CAMSHAFT ASSEMBLY-Used on AFV3100-1000	6-23	31009	1
	*CAMSHAFT ASSEMBLY-Used on FV3100-1000 Types C	6-340-5	91610-A	1
12	CAP-Fuel Tank	45-181	91232	1
13	CAP & GASKET ASSEMBLY-Oil Filler	45-179	5095-1	1
14	CARBURETOR ASSEMBLY-Clinton	P39-566-5	P14666	1
	NOTE: Carburetor is the same as 14355 Carburetor, except use 14331-A (6-166-6) Choke Shaft, 14570-A (6-104-5) Throttle Shaft, 14714 (293-138) Valve Throttle, 14582-A (181-5-5) Needle Ass'y Power Adjusting. Refer to Sec. III, Div. A, Page 17.			
15	CLAMP-Remote Control	81-13	31463	1
16	CLEANER ASSEMBLY-Air (Used on Type A)	149-396	91664	1
	NOTE: Assembly incl. Ref. Nos. 25, 35 and 66.			
	*CLEANER ASSEMBLY-Air (Used on Types B & C)	149-478	92102	1
	NOTE: Assembly incl. Ref. Nos. 25, 31, 35, and 66.			
17	CLIP-Ignition Shorting	266-28	3499	1
18	CLIP-Coil-Holding	P81-20	P5734	1
19	COIL-Magneto (Without Laminations)(Used on Type A)	P135-215	P5733-A	1
	*COIL-Magneto (Without Laminations)(Used on Types B & C)	P135-13-5	P5770	1
20	CONDENSER-Magneto	P135-29-5	P5589-A	1
21	CONNECTOR-Flexible Fuel Line (Carburetor)	69-123	91170	1
22	CONNECTOR-Hose to Fuel Tank	69-25	5054	1
23	CORE & BREAKER BOX ASSEMBLY-Incl. Ref. No. 18	P135-37-5	P5732	1
24	COVER-Dust (Magneto Breaker Points)	P45-15	P5743	1
25	COVER-Air Cleaner (Used on Type A)	45-175	91004	1
	*COVER-Air Cleaner (Used on Types B & C)	45-337	91815	1
26	COVER-Valve Chamber	45-304	91466	1
27	CRANKSHAFT-Used on FV3100-1000	46-414	31128	1
	CRANKSHAFT-Used on AFV3100-1000	46-484	31324	1
28	CUP & PAWL ASSEMBLY-Recoil Starter	P149-99	P6387	1
	*CUP-For Cam Starter (Not illus.)	P265-10	P90871	1
	DECAL-Arrowhead	58-25	90559	1
30	DECAL-Horsepower	58-153	91233	1
31	DECAL-Air Cleaner (Used on Type A)	58-20	3461	1
	*DECAL-Air Cleaner (Used on Types B & C)	58-349	91767	1
33	DEFLECTOR-Air	259-358	91043	1
34	ELBOW-Breather	69-23	90610	1
35	ELEMENT-Air Cleaner (Used on Type A)	P2-99-99	P91100	1
	*ELEMENT-Air Cleaner (Used on Types B & C)	2-140-99	91791	1
36	FELT-Lubrication (Cam Follower)	P94-189	P5742	1
37	FLYWHEEL ASSEMBLY	83-10-5	5752-A	1
38	GASKET-Adapter to Block	94-68	7149	1
39	GASKET-Carburetor to Adapter	94-69	7168	1
40	GASKET-Air Cleaner to Carburetor (Used on Types A, B&C)	94-13	31445	1
	*GASKET-Air Cleaner to Carburetor (Used on Types B & C)	94-458	92098	1
41	GASKET-Cylinder Head	94-40	10253	1
42	GASKET-Engine Base (.015 Thick)	94-107	10254	1
	NOTE: .010 thick gasket available	93-107	10254-1	1
43	GASKET-Cover, Dust, (Breaker Points)	P94-241	P5744	1
44	GASKET-Oil Filler Cap	94-82	5097	1
45	GASKET-Spark Plug	94-90	3115	1
46	GASKET-Valve Chamber Cover	94-103	10251	1
	GASKET KIT-Engine Overhaul	149-361	91562	1
47	HEAD-Cylinder	122-17	31011	1
48	HOUSING & BRACKET ASSEMBLY-Blower	259-379	91224-A	1
49	KEY-Flywheel	148-4	10339	1
50	LEAD-Hi-Tension (Magneto)(Used on Type A)	P307-190	P5555	1
	*LEAD-Hi-Tension (Magneto)(Used on Types B&C)	P307-194-5	P90761	1
51	LINE-Flexible (Fuel)	158-25	6316	1

52	LINE-Oil Distributor (Oil Pump)	158-53	10390	1
53	LINK-Carburetor to Air Vane	159-73	91152	1
54	LOCK-Connecting Rod Screw	148-12	21318	1
	MAGNETO ASSEMBLY-Used on Types A	P268-4-5	P5731	1
	NOTE: Assembly incl. Ref. Nos. 8, 18, 19, 20, 23, 24, 36, 43, 59, 83, 92, 93, 104, 110 and 116.			
	*MAGNETO ASSEMBLY-Used on Types B & C	P268-17-5	P91740	1
	NOTE: Assembly incl. Ref. Nos. 8, 18, 19, 20, 23, 24, 36, 43, 59, 83, 92, 93, 104, 110 and 116.			
55	MUFFLER	170-36-5	3639	1
56	NUT-Fuel Tank Straps	183-53	3253	2
57	NUT-Hex, 1/2-20 (Starter Cup)	183-68-99	5942	1
58	NUT-Lock, Muffler	183-37	4425	1
59	NUT-Terminal Condenser Lead	P183-21	P5740	1
60	NUT & L'WASHER-Carburetor to Adapter	183-29-5	3255-A	2
61	NUT & L'WASHER ASS'Y-Recoil Starter	183-25-5	4107-A	4
62	PIN-Camshaft Ax. e (Used on FV3100-1000 Types A & B)	203-20	10392	1
63	PIN-Pivot, (Air Vane Governor)	203-91	90982	1
64	PIN-Wrist	203-63	6024	1
65	PISTON ASSEMBLY-Standard	204-13-5	31001-A	1
	NOTE: Assembly incl. Ref. Nos. 64, 65, 73, 74, 75 & 76.			
	NOTE: Piston Assemblies are available in the following oversizes:	205-13-5	31001-A (.005)	
	.005, .010, .020, .030, .040. Order by Part Number and	206-13-5	31001-A (.010)	
	specify oversize.	207-13-5	31001-A (.020)	
	IBM Part No. Oversize Listed	208-13-5	31001-A (.030)	
		209-13-5	31001-A (.040)	
66	PLATE-Air Cleaner Mounting (Used on Type A)	2-102	91162	1
	*PLATE-Air Cleaner Mounting (Used on Types B & C)	2-144	91802	1
67	PLATE-Name (Air Deflector)	58-105	6530	1
68	PLATE-Valve Spring Retainer	215-136	10013	1
69	PLUG- 3/8 N. P. T. (Oil Drain)	216-25	5655	1
70	PLUG-Oil Drain	216-24	5649	1
71	PUMP ASSEMBLY-Oil	220-5-5	10385-A	1
72	RETAINER-Valve Spring	304-135	3028	2
73	RING-Compression (Standard) Order Ring Set		6026	1
74	RING-Oil, (Standard) Order Ring Set		6006	1
75	RING-Retainer (Wrist Pin)	232-41	6034	2
76	RING-Scraper (Standard) Order Ring Set		6027	1
	RING SET-Standard	149-10	10023	1
	NOTE: Ring Sets are also available in the following oversizes:	149-157	10023 (.005)	
	.005, .010, .020, .030 and .040. Order by Part Number	149-158	10023 (.010)	
	and specify oversize.	149-159	10023 (.020)	
	IBM Part No. Oversize Listed.	149-160	10023 (.030)	
		149-161	10023 (.040)	
77	RIVET-Tubular (Name Plate)	244-21	5460	4
78	ROD ASSEMBLY-Connecting	245-102-5	31002-A	1
	NOTE: Assembly includes Ref. Nos. 54 and 79.			
	*SCREEN-For Cam Starter (Not Illustrated)	257-30	90872	1
79	SCREW-H. H. C., 1/4-28x1 1/4 (Connecting Rod Cap)	258-9	3235	2
80	SCREW-H. H. S. T., #8-18-14 (Shroud to Brackets)	258-160	5934	4
81	SCREW-H. H. Slotted S. T., #8-32x3/8(Deflector to Block)	258-81	5644	2
82	SCREW-H. W. H., 5/16x 1 7/8(Cylinder Head)	258-88	5654	9
83	SCREW-R. H. S. T., #8-32x4/5 (Condenser to Plate)	P258-299	P5741	1
84	SCREW-H. H. S. T., #8-32x1/4 (Shroud to Bracket)(Clamp to Shroud)	258-477	5892	3
85	SCREW-H. H. C., #8-32x7/16 (Air Cleaner to Carburetor)(Used on Type A)	258-131	5812*	2
	*SCREW-H. H. S. T., #8-32x1 1/4 (Air Cleaner to Carburetor)(Used on Types B & C)	258-902	92025	2
86	SCREW-H. H. C., 1/4-28x1 (Carburetor to Adapter)	258-190	7205	1
87	SCREW & L'WASHER ASS'Y-H. H. C., 1/4-20x1/2 (2-Blower Housing to Block)(1-Bracket to Block)	258-280-5	3205-G	3
88	SCREW & L'WASHER ASS'Y-H. H. C., #8-32x3/8(Bracket to Carburetor)	258-81-5	5644-A	2
89	SCREW & L'WASHER ASS'Y-H. H. C., 1/4-20x1 1/4 (Base to Block)	258-254-5	5613-G	7
90	SCREW & L'WASHER ASS'Y-H. H. C., #10-24x1/2 (Valve Chamber Cover)	258-82-5	5645-A	2
91	SCREW & L'WASHER ASS'Y-R. H. M., #10-24x3/4 (Fuel Tank Straps)	258-185-5	3238-A	2
92	SCREW & L'WASHER ASS'Y-P. H. S. T., #10-24x1 (Lamination to Block)	258-108-5	5682-A	2
93	SCREW & L'WASHER ASS'Y-O. H. Slotted #8-32x9/16 (Breaker Points to Breaker Box)	P258-297-5	P5737	1
94	SCREW & L'WASHER ASS'Y-H. H. C., 1/4-20x7/8 (Adapter to Block)	258-284-5	3294-G	2
95	SEAL-Oil (Engine Base)	94-176	9029	1
96	SEAL-Oil (Block)	94-178	10012	1
97	SEAL-Oil, Aux. P. T. O. (Used on AFV3100-1000)	94-170	4555	1
98	SHROUD ASSEMBLY-Blower Housing	259-376-5	91220-A	1
99	SHROUD ASSEMBLY-Carburetor	259-375	91219	1
100	SLIDE ASSEMBLY-Governor Regulating	26-236-5	91330	1
100-A	*SPACER-Air Cleaner (Used on Types B & C)	900-340	91881	1
101	SPARK PLUG & GASKET ASSEMBLY	K267-28-5	K16303-A	1
102	SPRING-Extension (Speed Regulating)	263-69	90635	1
103	SPRING-Valve	263-92	3068	2
104	SPRING-Breaker Box Cover	P263-10	P5745	1
105	STRAP ASSEMBLY-Fuel Tank	26-351-5	91226-A	2
106	STARTER ASSEMBLY-Recoil	P265-123-5	P90996	1
	*STARTER ASSEMBLY-Recoil (Cam Type)	P265-28-5	P13516	1
107	STUD-1/4-28x1 (Carburetor Adapter)	24-13	6155	1
108	TANK ASSEMBLY-Fuel	277-229-5	91229-A	1
109	TAPPET-Valve	278-5	10009	2

SEC. II, DIV. FV-3100-1000
 AFV-3100-1000
 PARTS CATALOG
 Revised May, 1961
 Supersedes March, 1960

S E R I E S
FV-3100-1000
AFV-3100-1000
 C L I N T A L L O Y

BASIC
 TYPE

CLINTON

110	TERMINAL-Jamtite Breaker Points.....	P307-230	P5738	1
111	VALVE-Exhaust	291-8-	10301	1
	VALVE-Exhaust (.010 Oversize)	292-6	10321	1
112	VALVE-Intake	291-7	10302	1
	VALVE-Intake (.010 Oversize)	292-7	10322	1
113	VANE-Air Governor	107-30	91033	1
114	WASHER-"C" (Valve Keeper).....	304-9	3291	2
115	WASHER-Starter Cup	304-5	5879	1
116	WASHER-Terminal Condenser Lead	P304-290	P5739	1
117	*WASHER-Air Cleaner (Used on Types B & C)	304-562	92024	1

* Indicates New Part Nos. Listed For The First Time.